

CITY OF SNYDER TYPICAL DIAGRAM FOR RESIDENTIAL ADDITIONS & ACCESSORY STRUCTURES

PLOT PLAN FOR ACCESSORY STRUCTURE

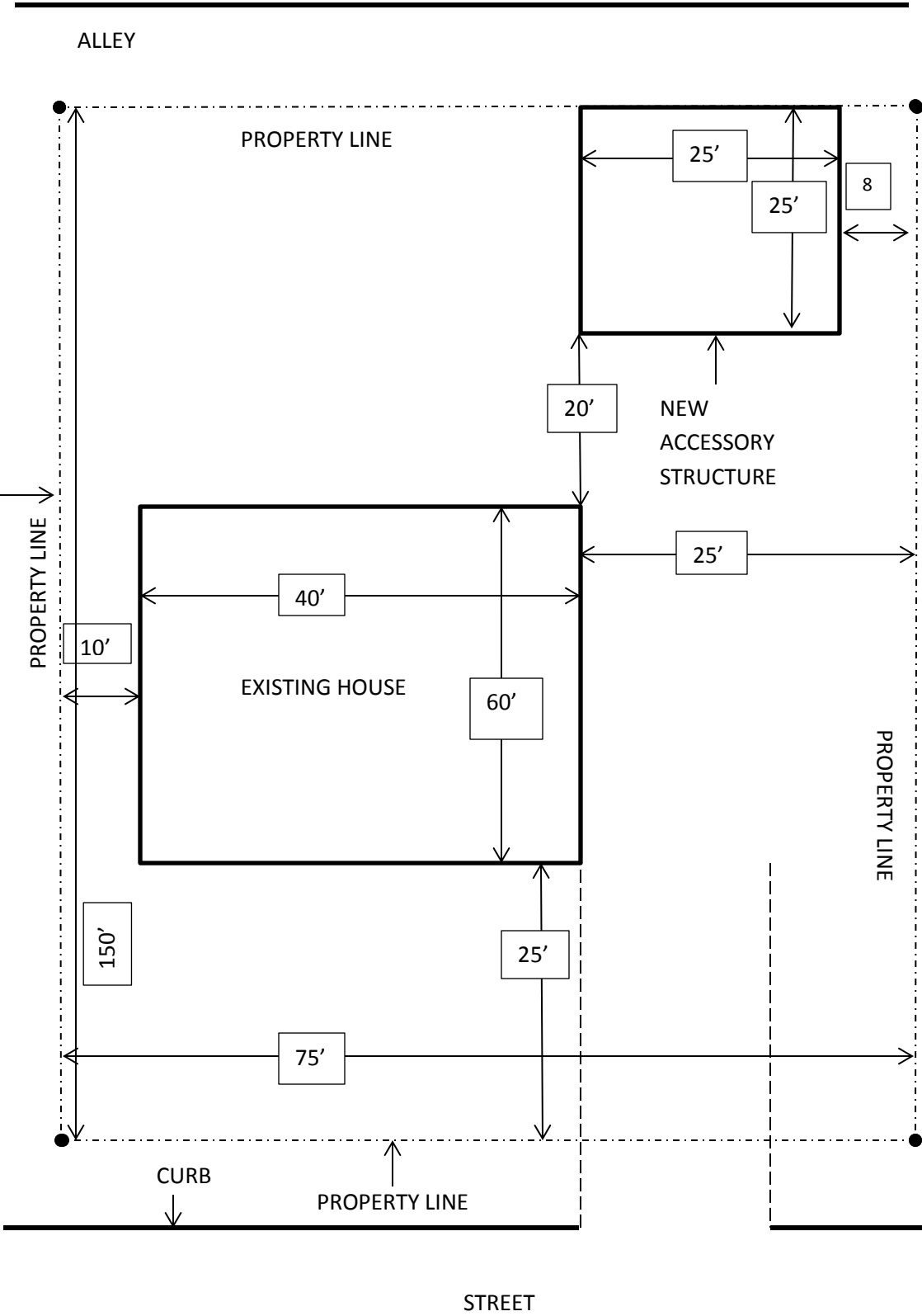

Front Yard Setback:

Not less than 25 feet from front property line to the front line of any structure.

Side Yard Setback:

R1: Not less than 8 feet from side property line to any structure.

R2: Not less than 6 feet from side property line to any structure.

R3: Not less than 5 feet from any structure.

Rear Yard Setback:

Not less than 20 feet from any structure.

Accessory buildings may be built in a required rear yard but such accessory buildings shall not occupy more than 30 per cent of a required rear yard and shall not be nearer than five feet to any side lot line. Where an alley exists at the rear of the property, an accessory building may be located on the property line. Where there is no alley, the accessory building must be a minimum of 12.5 feet from the rear property line. Any accessory building located within ten feet of the main building shall be considered a part of the main building, not an accessory building.